

# Toggle Fork End

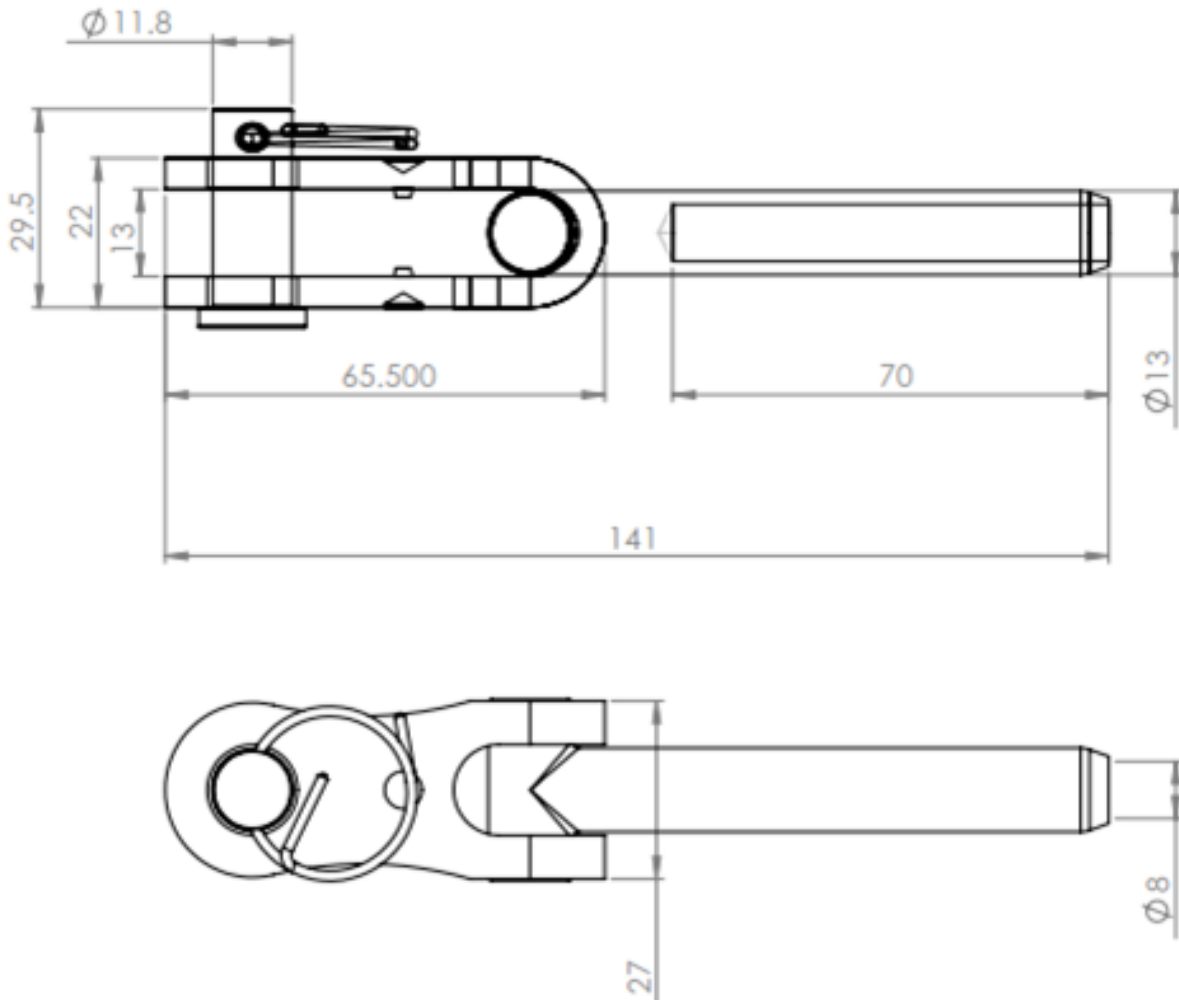

## Specification

<b>Product code</b>	FP-AC-TF
<b>Material number</b>	1520785
<b>Material</b>	Stainless steel grade 316
<b>Finish</b>	Polished
<b>Weight (kg)</b>	0.195
<b>Quality</b>	ISO 9001
<b>Conformity</b>	EN 795:2012, CEN/TS 16415:2013

---

**Application**

Toggle Fork End termination to be fitted to start/end component on Soter™ high load or rigid structure/wall to approved termination point. Wire should be crimped inside hollow section with 5 no. 130kN swages. Please refer to SFS Fall Protection Installation Manual.

---

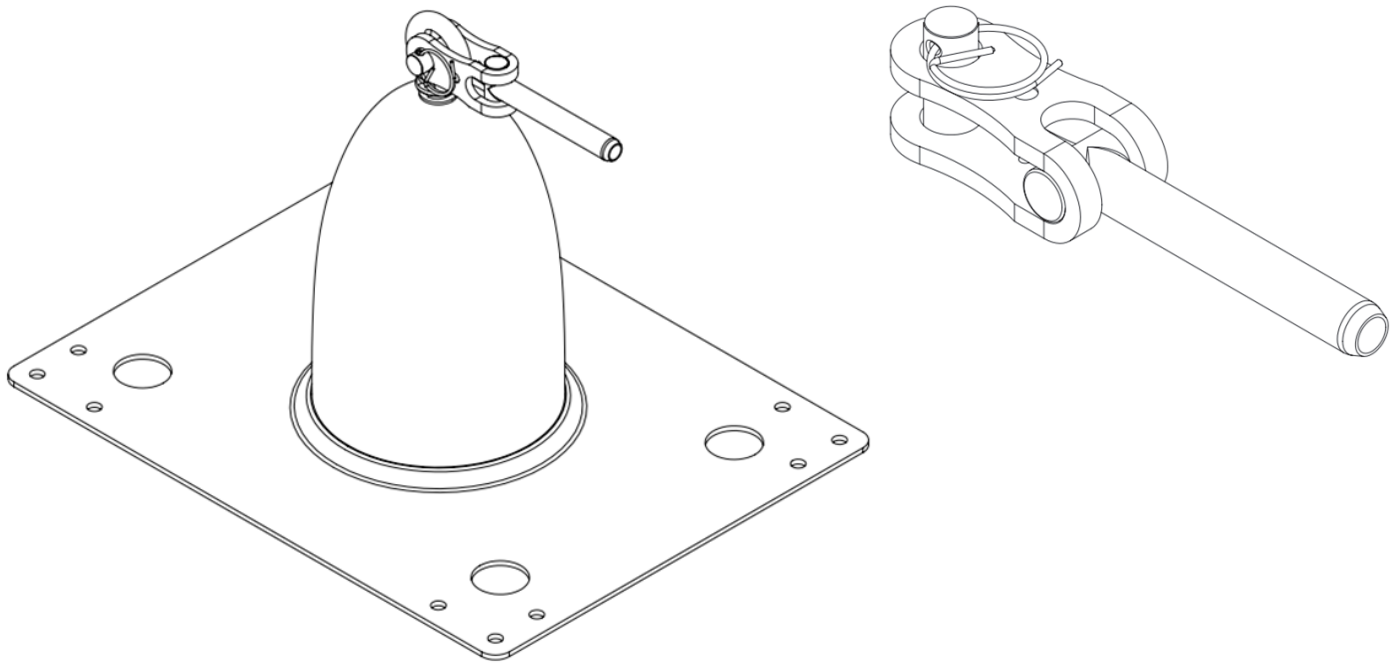

The details stated are results of tests and/or calculations and therefore are non-binding and do not represent guarantees or warranted characteristics for not specified applications. All calculations therefore have to be checked and approved by the responsible planner ahead of execution. The user is responsible to assure compliance with all applicable laws and regulations.